

# Boat Paint Guide

With removable color card

Canadian Edition



# That Feeling...

...where the breeze is perfect, the water magnificent, you soar over the waves and everything is just right. That sense of freedom and relaxation on being on the water, along with the sense of pride and confidence in choosing the best products to protect and enhance your boat.

Like you, we share that love of boating too, it's the foundation of our research, which is why Interlux has the full range of coatings that inspire the confidence and reassurance you need to get out there and enjoy that feeling every time you set out on the water

## Ask the experts

At Interlux®, we recognise the importance of providing high-quality technical support and advice to all our customers. Whether you're a novice or a more experienced DIY'er, you're sure to have a question for us – and we'd love to help – here's how you can reach us...



[interlux.com](https://interlux.com)



Product Data Sheets



[interluxtechnicalservice@akzonobel.com](mailto:interluxtechnicalservice@akzonobel.com)



Material Safety Data Sheets



+44 (0) 1489 77 50 50



Product Labels

**Got a question? We've got experts who've got the answer!**

---

## Interlux® and the environment

We have products and systems designed to help you reduce your boating environmental footprint. Call us or visit [interlux.com](https://interlux.com) for more information.

# Contents

## Boat Paint Guide

### Antifoulings

- 4 Product guide
- 8 Is my new antifouling compatible?
- 9 How much antifouling paint do I need?
- 10 Below water systems:
  - Two-part products
  - One-part products
  - No sand systems
  - Propellers, outdrives and running gear

### Topsides

- 14 Product guide
- 16 Topsides paint systems:
  - Two-part premium paint systems
  - One-part conventional paint systems
- How much topside paint do I need?

### Varnishes

- 18 Product guide
- 20 Sikkens® Cetol® Marine
- 21 Varnish systems:
  - Two-part premium system
  - One-part conventional system
  - Sikkens® Cetol® Marine system

### Primers & Thinners

- 7 Why do I need a thinner?
- 22 Product guide

### Blister repair and prevention

- 24 How to protect against osmosis
- 25 Osmosis protection systems

### Undercoats

- 26 Product guide

### Before you start

- 27 Health & safety

### Glossary of terms

All statements, technical information and recommendations contained in this publication are based on tests and working practice believed to be reliable, but their accuracy and/or completeness is not guaranteed. The user shall determine the suitability of the products for his/her particular purpose and shall assume all risk and liability herewith. Printed in the UK using vegetable oil and naturally occurring resin-based inks.

All trademarks mentioned in this publication are owned by, or licensed to, the AkzoNobel group of companies.

© AkzoNobel 2022



# Antifoulings

## Product guide

Use this guide to our antifouling products to help you choose the perfect product for your project.



<b>Key attributes</b>	
<ul style="list-style-type: none"><li>• Premium multi-season performance</li><li>• Polishes to minimize paint build up</li><li>• Can be applied at lower temperature 5°C / 41°F</li><li>• Compatible over most antifoulings</li><li>• Suitable for power and sail, in all waters</li><li>• Can be applied to properly primed aluminum</li></ul>	
<b>Thinners</b>	216
<b>Practical coverage (ft²/gallon)</b>	454
<b>Number of coats</b>	2
<b>Substrates</b>	FRP / W / S / A / L / GS
<b>Safe for use on aluminum</b>	<div></div>
<b>Application method</b>	Brush / Roller

For comprehensive application and system information, always read the technical data sheet before you start.

FRP Fiberglass    W Wood    S Steel    A Aluminum    L Lead    GS Galvanised Steel





Ablative

Bottomkote®-CA

- Premium season-to-season ablative protection
- Use on power and sail boats in all waters
- Can be applied to properly primed aluminum

216

454

2

FRP / W / S / A / L / GS



Brush / Roller



Additional High Perform

VC Offshore

- For racing, sailing and power boats
- Suitable for salt and freshwater
- Fluoro microadditive provides a low friction surface for a high performance finish
- Hard, smooth finish can be burnished to a very low profile

216

300

2 minimum

FRP / W / S / L / GS



Brush / Roller



## Antifouling Products

### VC 17m

Extra strong thin film antifouling for racing sailboats and powerboats  
With fluoro microadditive for low friction, hard, smooth surface  
Quick drying for fast relaunch  
OK for use on inflatables

216

340

2-3

FRP / W / S / L / GS



Brush / Roller



## Non-Antifouling

### VC Performance Epoxy

- Two-part epoxy designed for use on the underwater surfaces of boats that do not require antifouling paint such as high performance, rack-stored or trailered boats
- Hard, semi-gloss, white finish is ideal for wet sanding and burnishing

216

200 (Spray)

2-3

FRP / W / S / L / GS



Brush / Roller / Spray

**Need to know how to remove old antifouling?**

The answer is only a click away at [marinemart.com](http://marinemart.com)

# Why do I need a Thinner?

## Product guide

Thinners are solvents which are usually the same, or very similar, to those used within the product they are recommended with. Thinners can be used as an additive to ease application, or to clean brushes and equipment.



To find out which thinner you need to use, refer to the chart below:

Product	Brush Spray Cleanup			% Thinner required	
	Brush	Spray	Cleanup	Brush	Spray
<b>Perfection® Epoxy Primekote</b>	2333N	2316N	2333N or 2316N	As required 5-10%	As required 25-35% max.
<b>Brightside Bilgekote Varnishes</b>	333	216	216	As required 10% max.	10-15%
<b>Bottom Paints (Conventional)</b>	–	N/A	216	10% 1st coat wood only	–
<b>Micron® CSC Tri-Lux II</b>	–	N/A	216	As required 10% max.	–
<b>Micron CSC-CA</b>	–	N/A	216	As required 10% max.	–
<b>Fiberglass Bottomkote ACT</b>	–	N/A	216	10% 1st coat wood only	–
<b>Bottomkote-CA</b>	–	N/A	216	10% 1st coat wood only	–
<b>VC Offshore</b>	–	N/A	216	10% 1st coat wood only	–
<b>VC 17m</b>	–	N/A	216	10-15% max.	–
<b>InterProtect 2000E</b>	2333N	2316N	2333N/ 2316N	5-10%	10-15%
<b>VC Performance Epoxy</b>	2333N	2316N	2333N/ 2316N	5-10%	10% max.

### Fiberglass Surface Prep YMA601V

Fiberglass Surface Prep YMA601V is a low VOC contamination/mold release agent remover used for preparing fiberglass bottoms of new boats or unpainted hulls before applying primers or antifouling paints. Removing contaminants from fiberglass is extremely important if full adhesive qualities of primers and/or antifouling paint are to be realized. It can also be used for the removal of amine blush from clear epoxy and cleaning previously painted surfaces prior to sanding before repainting topside finishes. Fiberglass Surface Prep YMA601V is ideal for preparing inflatable boats for a compatible antifouling system.



# Antifouling

## Is my new antifouling compatible?

Once you've identified the Interlux antifouling that's most suitable, if you have an existing coating on your hull you will need to establish the compatibility of the two products. Use this simple table to check compatibility between Interlux® antifoulings and also with competitor products.

		Old Antifouling						
		Micron® Extra, Micron® CSC Trilux II, Ultima	Fiberglass Bottomkote ACT Horizons	Ultra, Trilux 33 Fiberglass Bottomkote, Epoxycop	Trinidad SR, Unepoxy	Bottomkote, Bottomkote XXX	VC® Offshore, Baltoplate or Vinyl Antifouling Paints	VC®17m Extra VC®17m
New Antifouling	Micron® CSC	■	■	■	■	●	■	●
	Micron CSC-CA	■	■	■	■	●	■	●
	Bottomkote-CA	■	■	■	■	■	■	●
	Fiberglass Bottomkote ACT	■	■	■	■	●	■	●
	Fiberglass Bottomkote	★	★	■	■	●	■	●
	Tri-Lux II	■	■	■	■	●	■	●
	VC17m	●	●	●	●	●	■	▲
	VC Offshore	●	●	●	●	●	■	●
	Bottomkote XXX	■	■	■	■	■	■	●

Ultima, Horizon, Trinidad, Unepoxy refer to products sold by Kop-Coat.  
Scotch-Brite™ is a trademark of 3M.

● Remove all paint   ★ Heavy sand & apply   ■ Lightly sand & apply   ▲ Clean & apply\*

\* Power wash and scrub with a coarse Scotch-Brite™ pad. Old antifouling must be well adhered.

Applying your desired Interlux® antifouling has never been easier. Compatibility is always an issue boaters must worry about, but there are 3 easy steps to solve this problem:



1. Check for compatibility with old antifouling. If you know what antifouling is currently on your boat, you can quickly determine whether your Interlux paint choice is compatible.
2. Use Primocon YPA984 as a tie-coat primer. If you do not know what the old antifouling is on your boat, it is still easy. Apply our Primocon YPA984 primer directly to the old antifouling. Then simply overcoat with the Interlux antifouling of your choice. (Not compatible with VC® Offshore, or VC17m)
3. Remove old antifouling. If you would prefer to remove the old antifouling, use a non methaline chloride based paint stripper. Paint stripper can remove several coats of paint in one application. After stripping, you are ready to prime and paint your newly cleaned hull.

**Important:** Now that you've stripped your hull, it is important to inspect for any gelcoat damage before repainting. Also, consider applying the InterProtect® System to give your hull a barrier coat to protect from gelcoat blistering.

## How much antifouling paint do I need?

Determining how much antifouling you will need is fairly simple. Here are two quick guides to help you purchase the correct amount:

1. Calculate the area needing paint. For a rough estimate of the area to be painted, multiply the length of your hull (LOA) by the beam and multiply by 0.85 (LOA x B x 0.85 = Area). Then divide the area by the coverage of the paint you've chosen to determine how many quarts per coat you will need, or
2. Refer to the reference chart below for a quick estimate of how much antifouling paint is required for two coats:

	Power					Sail				
										
	Power					Sail				
Waterline length (feet)	20	25	30	35	40	20	25	30	35	40
Standard range*	4.0	5.0	7.0	9.5	12.0	3.0	4.0	5.5	7.0	9.5
VC®17m*	3.0	4.0	5.5	7.0	9.5	2.5	3.0	4.5	5.5	7.5

\* Quarts

LOA Length Overall    LWL Length Waterline    B Beam    D Draft    F Freeboard

### Top Tips

- Apply an extra coat to all leading and trailing edges, water-line, trim-tabs, outdrives, keel and rudder. High turbulence in these areas tends to wear the antifouling faster.
- Always use the specified amount of antifouling. Under-application can result in premature fouling and costly mid-season haul out.

For more information see the Antifouling product guide on Page 04.

# Antifouling

## Below water systems: Two-part products

These systems provide the maximum level of protection against corrosion and osmosis.

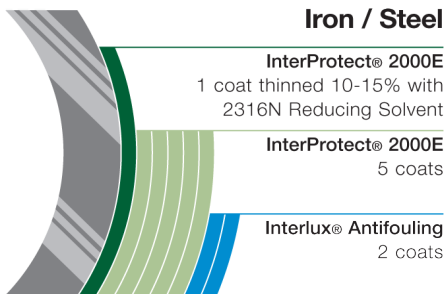
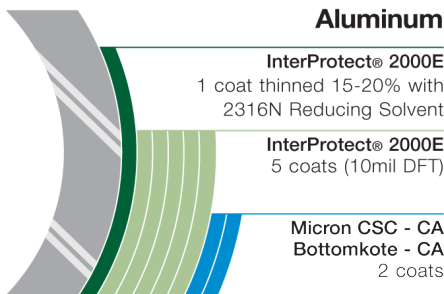
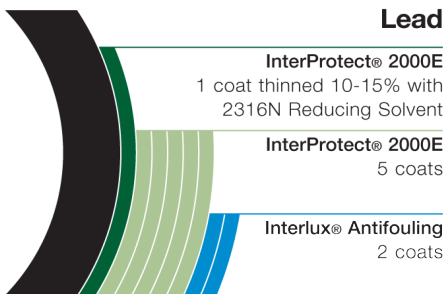
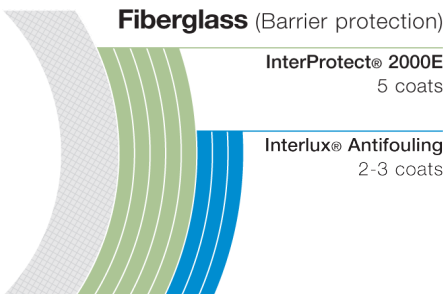

### Filler

If required for small areas,  
Watertite Filler should be applied  
after the first coat of InterProtect.



**Important:** If you own an aluminum boat, only  
apply antifouling paints specifically recommended  
for aluminum and follow the proper priming  
instructions.

Consult your owner manual for manufacturer  
recommendations prior to applying products on  
your aluminum boat and accessories, including  
outdrives.

- Surface Primer
- Primer
- Antifouling

# One-part products

These systems provide a good level of protection.

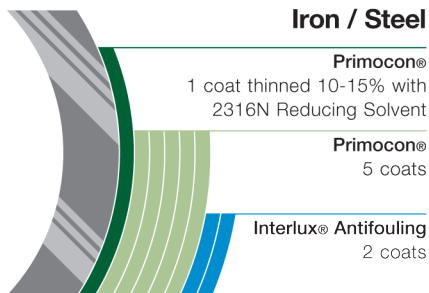
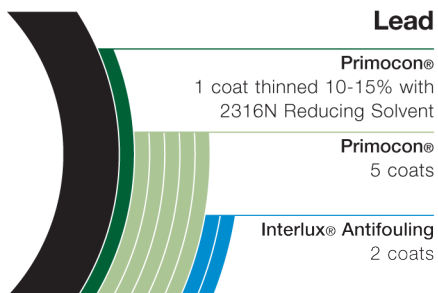

## For technical service, please ask the experts!

We will help you throughout your project, with tips on preparation, application and maintenance. Please feel free to contact us, via one of the following methods:

**1 800 468-7589**

[Interluxtechnicalservice@akzonobel.com](mailto:Interluxtechnicalservice@akzonobel.com)

[interlux.com](http://interlux.com)

- Surface Primer
- Primer
- Antifouling



# Antifouling

## Ultimate no sand systems

### Fiberglass

#### Fiberglass Surface Prep YMA601V

InterProtect® 2000E  
1 coat

Interlux® Antifouling\*  
2 coats

\*Excluding VC17m, VC Offshore, or  
VC Performance Epoxy

This system will not provide  
blister protection.

### Fiberglass Surface Prep YMA601V

- Water-based fiberglass surface preparation to be used in no sand systems
- Removes contamination, mold release agents, wax and amine blush
- Can be used to clean previously painted surfaces before repainting topside finishes and below the waterline
- Ideal for preparing inflatable boats for antifouling



See osmosis protection systems on Page 25.



- Surface Primer
- Primer
- Antifouling

# Propellers, outdrives and running gear

Outdrives are built out of aluminium. Care must be taken to ensure that the proper amount of recommend primer and the proper antifouling is used. We recommend that you consult your owners manual on your outdrive and underwater metal parts prior to applying this system. Propellers are typically made with aluminium, bronze or stainless steel.

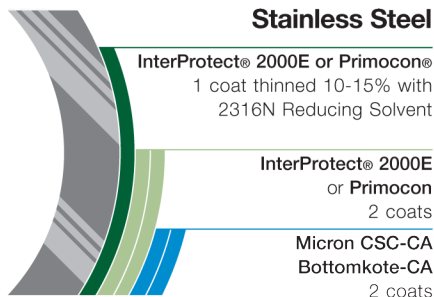
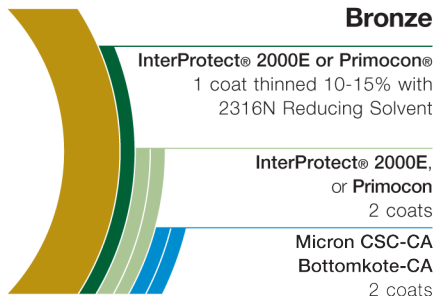
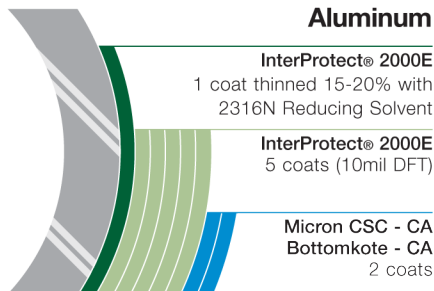

- Surface Primer
- Primer
- Antifouling

# Topsides

## Product guide

Use this guide to our topside products to help you choose the perfect product for your project.



	Brightside®	Interdeck
Key attributes	<ul style="list-style-type: none"><li>• Hard, high gloss one-part polyurethane finish</li><li>• Excellent flow and leveling characteristics yield that 'sprayed on' look when brush applied</li><li>• Ideal for use anywhere above the true waterline</li><li>• Full range of bright, crisp colors</li></ul>	<ul style="list-style-type: none"><li>• Slip resistant polyurethane deck paint</li><li>• Contains fine mineral additive for hard wearing, non-slip surface</li><li>• Suitable for all substrates</li><li>• Low sheen finish prevents sunlight glare</li><li>• Apply straight from the can with brush or roller</li></ul>
Thinners	333 Brush / Roller 216 Spray	333 Brush / Roller
Practical coverage (ft²/gallon)	495	396
Number of coats	2-3	1-2
Substrates	FRP / W / S / A	FRP / W / S / A
Application method	Brush / Roller / Spray	Brush / Roller
Recommended undercoat	Epoxy Primekote® or Pre-Kote	Epoxy Primekote® or Pre-Kote
For a satin finish add	Flattening Agent YMA715	–
For a no-skid finish add:	Intergrip No Skid Compound 2398C	–

FRP Fiberglass    W Wood    S Steel    A Aluminum



## Bilgekote®

- Hard wearing coating for bilges and bulkheads
- Chemical resistance to fumes, fuel and oil
- High opacity for thorough coverage
- Cleans easily for reduced upkeep

333 Brush / Roller  
216 Spray

321

1-2

FRP / W / S / A

Brush / Roller / Spray

Epoxy Primekote® or Pre-Kote

Flattening Agent YMA715

—

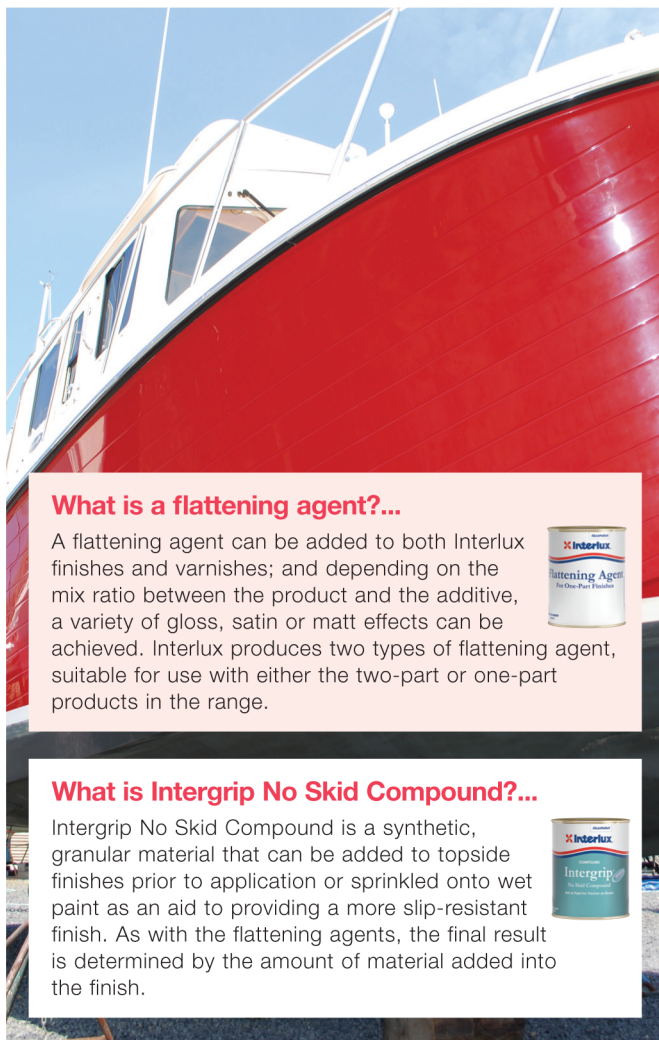

## What is a flattening agent?...

A flattening agent can be added to both Interlux finishes and varnishes; and depending on the mix ratio between the product and the additive, a variety of gloss, satin or matt effects can be achieved. Interlux produces two types of flattening agent, suitable for use with either the two-part or one-part products in the range.



## What is Intergrip No Skid Compound?...

Intergrip No Skid Compound is a synthetic, granular material that can be added to topside finishes prior to application or sprinkled onto wet paint as an aid to providing a more slip-resistant finish. As with the flattening agents, the final result is determined by the amount of material added into the finish.



Further information on **Flattening Agent** and **No Skid Compound 2398C** and their uses can be found on the product label or on the product data sheets, which are available at [interlux.com](http://interlux.com)

# Topsides

## Topsides paint systems

These systems provide a good level of protection.

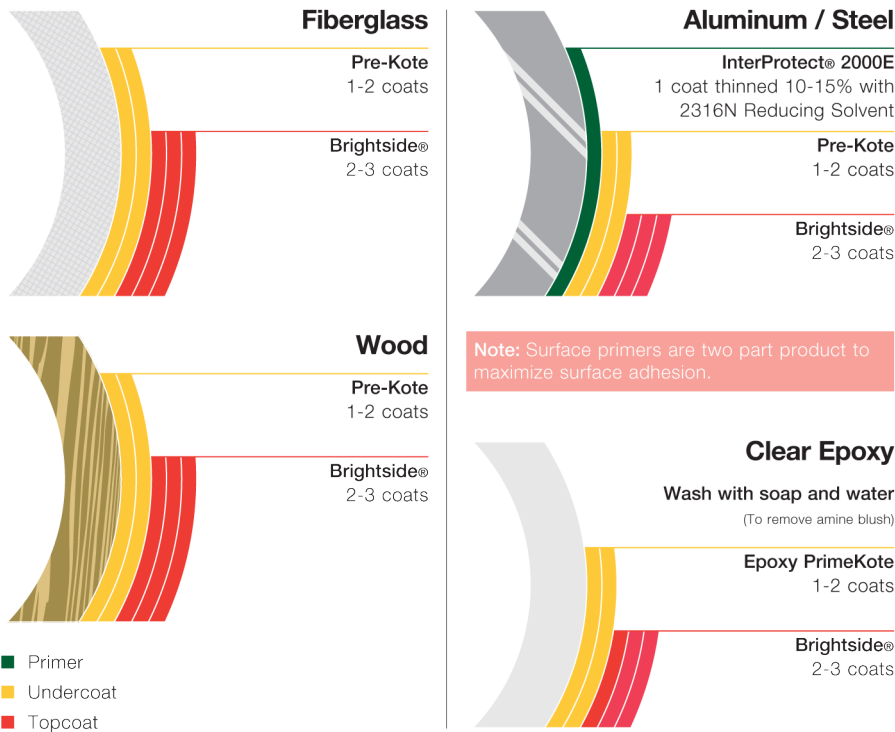

## How much topside paint do I need?

Determining how much paint you will need is fairly simple. To determine how much topside paint you will need, refer to the reference chart below:

	Power					Sail				
Waterline length (feet)	20	25	30	35	40	20	25	30	35	40
Topside finishes (quarts)	3.0	4.5	6.0	8.0	9.0	2.5	4.0	5.5	7.0	8.5
Finish primers (quarts)	4.0	5.5	7.5	10.0	11.0	3.0	5.0	7.0	9.0	10.5



You've painted your boat yourself and now it's time to stand back and admire your very own work of art. Looks good doesn't it?

That's how you will feel when you choose to use the vivid and high-performing, long lasting colors from the Brightside topside range.

Simple to apply, with a silky smooth flow and superb gloss retention, you will join the many boaters who have been painting their own colorful masterpieces with Brightside since 1988.

A track record like that gives confidence, so go on, choose Brightside and be amazed at what you can create.

**Brightside®. Create your masterpiece.**

# Varnishes

## Product Guide

Use this guide to our varnish products to help you choose the perfect product for your project.



	Perfection® Plus	Schooner® Gold
Key attributes	<ul style="list-style-type: none"><li>• Ultimate performance, clear, two-part polyurethane varnish</li><li>• Chemical cure for the hardest finish &amp; highest abrasion resistance</li><li>• Superior gloss lasts four times longer than conventional one-part varnishes</li><li>• Professional-quality results made easy</li><li>• 2:1 mix ratio: Easy to measure and mix</li></ul>	<ul style="list-style-type: none"><li>• Advanced UV technology in our longest-lasting one-part varnish</li><li>• Exceptional deep gloss and color are retained over the lifetime of the coating*</li><li>• Sand between every other coat</li><li>• Traditional amber color</li><li>• Designed for the experienced varnish enthusiast or professional</li></ul> <p>* Based on the results of our trials.</p>
Thinners	2333N Brush / Roller 2316N Spray	333 Brush / Roller 216 Spray
Coverage (ft²/gallon)	489	526
Number of coats <small>Will vary depending on usage. Please check product label/ data sheet.</small>	2-5	2-6
Suitable for use direct to oily wood (e.g. teak or iroko)	●	●
Application method	Brush / Roller / Spray	Brush / Roller / Spray
UV protection/gloss retention	● ● ● ● ●	● ● ● ●
For a satin finish add:	-	Flattening Agent YMA715

● Good      ● ● ● ● ● Outstanding





### Schooner®

- Premium quality, traditional tung oil varnish
- Rich golden color and deep gloss
- Excellent UV protection
- Good flow-out and self-leveling characteristics for easier application
- Suitable for interiors, exteriors and over existing varnish

333 Brush / Roller  
216 Spray

500

3-6



Brush / Roller / Spray



### Compass Clear

- High durability, high gloss polyurethane varnish
- A bright, clear, high gloss finish lets the natural color of the wood show through
- Contains a unique combination of UV additives, HALS, surface stabilizers and antioxidants for long-term gloss and clarity

333 Brush / Roller  
216 Spray

600

3-6



Brush / Roller / Spray



### Goldspar® Satin

- A satin finish polyurethane varnish for interior use
- Resistant to hot water, mild acids, alcohol and alkalis
- Fast-dry formulation minimizes dust contamination

333 Brush / Roller  
216 Spray

421

3-6



Brush / Roller / Spray

For interior use only

### Original

- Good flow, flexibility and gloss retention
- High clarity finish for light color woods
- Interior, exterior and over existing varnish

333 Brush / Roller  
216 Spray

476

4-6



Flattening Agent YMA715   Flattening Agent YMA715

-

**Note:** For a no-skid finish, use **Intergrip No Skid Compound** with your chosen varnish.

# Topsides

## Sikkens® Cetol® Marine

Cetol® Marine with Next Wave™ UV-absorbing technology is a durable, low maintenance translucent protective wood finish for use above the waterline on interior and exterior woods. Next Wave™ technology is the next generation of Cetol Marine from Sikkens with a unique UV package of advanced ultra violet absorbers that provide greater protection, durability and longevity. Cetol Marine has excellent weathering properties and is flexible allowing for the natural expansion and contraction of wood. Cetol Marine has been specially formulated with one goal in mind to protect wood and keep it looking beautiful.



### Cetol® Marine

Cetol Marine produces an attractive dark amber appearance on wood.



### Cetol® Marine Light

Cetol Marine Light will produce a lighter amber appearance on wood.



### Cetol® Marine Natural Teak

Cetol Marine Natural Teak has a rich golden color on wood.



### Cetol® Marine Gloss

Cetol Marine Gloss provides a high gloss, hard wearing, UV protection and an easy to clean finish and is developed as a topcoat for Cetol Marine, Cetol Marine Light and Cetol Marine Natural Teak for whenever a gloss finish is desired.

**Do not use on decks.**



# Varnish systems:

## Two-part premium system

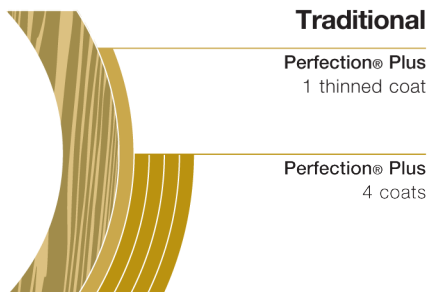

## One-part conventional varnish systems

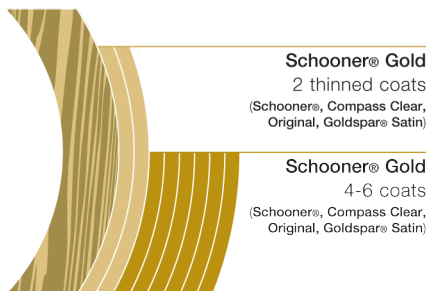

## Sikkens® Cetol® Marine system

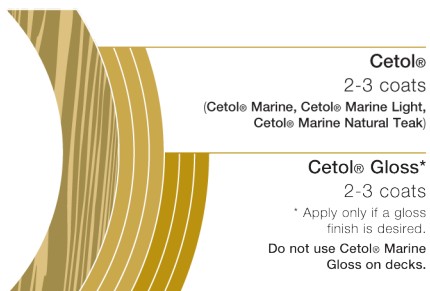

### Oily Woods

Hard woods such as Teak and Iroko, that are oily by nature, must be degreased adequately with the correct solvent prior to the application of a first thinned coat of varnish.

■ Primer

■ Varnish

# Primers

## Product guide

Use this guide to our primers and undercoats to help you choose the perfect product for your project.



Primer		
	InterProtect® 2000E	Primocon®
<b>Key attributes</b>	<ul style="list-style-type: none"> <li>• For prevention and repair of gelcoat blistering</li> <li>• Excellent for use on underwater metals, hulls and keels</li> <li>• Easy to apply – dries quickly – no sanding</li> <li>• Use as part of a no sand system</li> <li>• Excellent anti-corrosive protection above &amp; below the waterline</li> </ul>	<ul style="list-style-type: none"> <li>• Conventional one-part primer for use below water</li> <li>• Quick drying, with anticorrosive properties</li> <li>• Can be used under most antifoulings* or as a conversion coat over incompatible or unknown antifoulings</li> <li>* Over suitable primer</li> </ul>
<b>Typically used</b>	Universal primer for above and below the waterline	Below water, under antifoulings or to seal unknown antifoulings <b>Do not use with VC®17m or VC® Offshore.</b>
<b>Thinners</b>	2333N Brush / Roller 2316N Spray	216 Brush / Roller / Spray
<b>Practical coverage (ft<sup>2</sup>/gallon)</b>	240	300
<b>Number of coats</b>	1-5	2-3
<b>Substrates</b>	FRP / W / S / A / L / Z	FRP / W / S / A / L / Z
<b>Application method</b>	Brush / Roller / Spray	Brush / Roller / Spray
<b>Suitable for above waterline</b>	●	✗
<b>Suitable for below waterline</b>	●	●

FRP Fiberglass    W Wood    S Steel    A Aluminum    L Lead    B Bronze

## InterProtect® 2000E

### What is InterProtect® 2000E?...

**InterProtect 2000E** epoxy primer has been an industry choice for protection and repair since 1986. Favored by both consumers and professional applicators in boatyards all over North America, InterProtect 2000E remains a market leader in protective epoxy barrier systems for fiberglass hulls.

InterProtect 2000E is an excellent 'Keel to Mast' primer, i.e it can be used above and below the waterline on most substrates. InterProtect 2000E has a natural structure within the epoxy coating to create a barrier against water permeation, called **Micro-Plates**. Technically, the InterProtect Micro-Plates formula provides millions of overlapping microscopic plates. When bound, they create an overlapping barrier similar to shingles on a roof. This barrier eliminates any direct path for water migration.

If you have a new boat, protect your investment against water absorption that could lead to costly problems like crazing or cracking of gelcoat or even blisters. InterProtect 2000E will help you get the most out of your boat, for years to come. A hull well protected with a full InterProtect system has even been shown to increase the re-sale value of boats!

### How much do I need?

It is best to actually measure the wetted surface area of the hull. If this is difficult to do, a close approximation can be made by multiplying the length overall, times the beam, times 85% (L.O.A. x Beam x .85 = wetted surface area). Divide the wetted surface area by 60 for brush and roller applications and by 45 for spray application. The resulting number is the number of gallons that need to be applied to reach a 10 mil dry film thickness.

## High performance no-sand method for new or non-blistered hulls

Prepare the surface using Fiberglass Surface Prep YMA601V with a maroon, 3M Scotch-Brite® pad.

Apply 1 coat of InterProtect 2000E using a 3/8" solvent resistant nap roller. Appropriate coverage is 240 sqft/gal. To determine if the InterProtect 2000E is ready to overcoat, check the paint film using the 'Thumb Print' test\*. If the InterProtect feels tacky and you can leave a thumb print in the paint film with out getting any paint on your thumb, it is 'Ready-to-Overcoat'. Test the paint film in the area you started applying the primer no later than 30 minutes after starting the application.

Continue testing every 15 minutes using the 'Thumb Print' test until reaching the 'Ready-to-Overcoat' stage. Immediately, begin to apply the Interlux antifouling paint.

Apply 2-3 coats of Interlux antifouling paint.

**Do not use this system with VC® Offshore or VC®17m.**

## InterProtect® 2000E as a universal primer

InterProtect 2000E can be used above and below the waterline as a universal primer for all surfaces and has proven itself to be an excellent primer for all metals.

It also can be used as part of a no sand system.



Available in two colors, Gray and White, so you can alternate colors to ensure full coverage.



**2000E**  
Gray  
Y2000E



**2000E**  
White  
Y2002E



### The 'Thumb Print' Test...

To determine if the InterProtect 2000E is ready to overcoat, check the paint film using the 'Thumb Print' test. If the InterProtect feels tacky and you can leave a thumb print in the paint film without getting any paint on your thumb, it is 'Ready-to-Overcoat'.

Scotch-Brite® is a trademark of 3M.

# Blister repair and prevention

## How to protect against osmosis

### Health and Safety

Before commencing preparatory work, ensure the area you are working in is adequately ventilated. Ensure you are wearing the correct PPE; we recommend safety spectacles, goggles or visors, nitrile rubber gloves, overalls (ensuring skin is not exposed) and a solvent mask.



### Preparation

Remove all contamination from the surface using Fiberglass Solvent Wash 202 or Fiberglass Surface Prep YMA601V. Sand using 80-grit sandpaper. Remove the sanding residue using Fiberglass Solvent Wash 202.

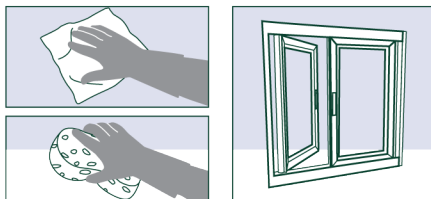

If your hull is **new**, proceed to **Step 4**.

### Inspection

Inspect the gelcoat for signs of damage or cracking. Small defects can be repaired with Watertite Epoxy Filler following the instructions on the product label.

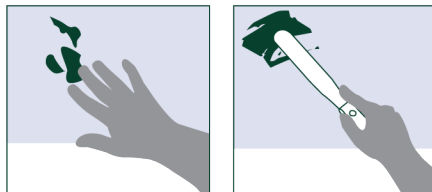

Look out for any warning signs that may suggest that water has entered the laminate or that osmosis may have occurred.

If more extensive damage is found or suspected we recommend that you seek the advice of a professional surveyor before continuing.

### Application

Apply InterProtect 2000E, building up to minimum dry film thickness of 10 mils (this will typically take 5 coats) using a brush or roller. For ease, alternate between the gray and white shades.

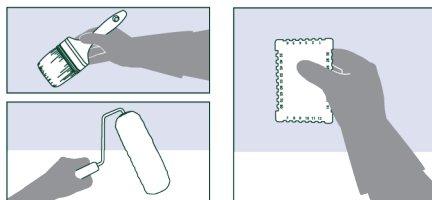

## Warning signs



### Blisters

Blisters can vary from small pinhead blisters, to areas as large as the palm of a hand. The presence of any fluid behind a blister indicates a potential problem.



### Star crazing

This effect can occur where the gelcoat is brittle. Fine cracks usually form due to severe flexing or impact damage, allowing water to seep into the laminate.



### Pinholes

Tiny bubbles present in the gelcoat reduce its effectiveness and promote rapid water absorption.



# Osmosis protection systems

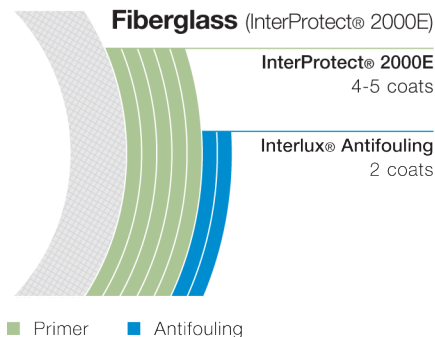

## How to treat osmosis

### 1. Proper preparation of the gelcoat:

This includes getting all of the antifouling paint and primers off and removal of as much gelcoat as necessary to get the hull dry (i.e. the entire gelcoat or just small areas). A professional, who has looked at your boat, should make this determination.

### 2. Drying of the hull:

This is the most critical step in the process. If you do not get the hull dry it will re-blister. We recommend a comprehensive washing and drying procedure.

### 3. Application of clear epoxy resin:

A solventless epoxy is recommended to seal up, laminate and fill any cloth that has been voided of resin.

### 4. Application of InterProtect® 2000E:

InterProtect® 2000E provides a water barrier to minimize the possibility of reoccurrence of damage and will act as a tie-coat to the antifouling. Contact our Technical Help Desk to obtain a copy of the InterProtect® Bulletin 900 at [interlux.com](http://interlux.com).

## InterProtect® 2000E

- For prevention and repair of gelcoat blistering
- Excellent for use on underwater metals, hulls and keels
- Easy to apply – dries quickly – no sanding
- Use as part of a no sand system
- Excellent anti-corrosive protection above and below the waterline



## Micro-Plates®

- Micro-Plates create an overlapping barrier to help stop water migration through the coating. The InterProtect system is the system of choice for repairing gelcoat that has already been damaged by osmotic blistering.

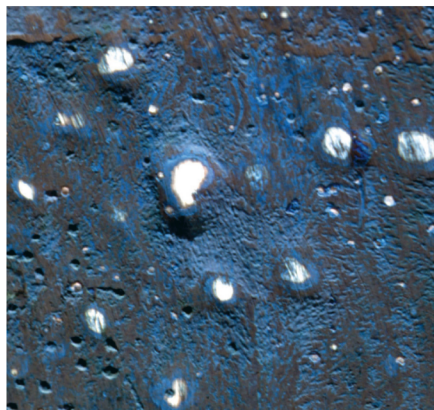



# Undercoats

## Product guide

Use this guide to our primers and undercoats to help you choose the perfect product for your project.



Undercoat		
	Epoxy Primekote®	Pre-Kote
Key attributes	<ul style="list-style-type: none"> <li>A multi-purpose epoxy primer for use with two-part finishes</li> <li>Use as part of a system to resurface cracked and crazed gelcoat</li> <li>Eliminates the effects of amine blush of clear epoxies</li> <li>Bright white color makes it ideal for priming bilge and locker areas</li> </ul>	<ul style="list-style-type: none"> <li>Undercoat for one-part finishes</li> <li>Contains Microspheres for superior build and hide, while improving flow and sandability</li> <li>Long-lasting, easy to apply and rub down</li> <li>Available in White and Gray</li> </ul>
Typically used	Above the waterline under Interlux two-part finishes or for priming clear epoxy resin	Above the waterline under Interlux one-part finishes <b>Do not use under two-part products</b>
Thinners	2333N Brush / Roller 2316N Spray	
Practical coverage (ft²/gallon)	450	420
Number of coats	1-2	1-2
Substrates	FRP / W / S / A / L	FRP / W / S / A
Application method	Brush / Roller / Spray	Brush / Roller / Spray
Suitable for above waterline	●	●
Suitable for below waterline	✖	✖

For comprehensive application and scheme information, always read the technical data sheet before you start.

FRP Fiberglass    W Wood    S Steel    A Aluminum    L Lead    B Bronze

# Before you start

## Health & safety

Our goal is to make paint application as safe as possible. Paint products legally require health and safety precautions which are made publicly available. Before beginning any paint project, please always read the label before use and follow all instructions. You can also find safety information at [Interlux.com](http://Interlux.com) in each product's Safety Data Sheet (SDS). General First Aid statements are provided below.

### Personal health

#### Avoid ingestion

If Swallowed: Call a poison control center or doctor immediately for treatment advice. Have person sip a glass of water if able to swallow. Do not induce vomiting unless told to do so by a poison control center or doctor. Do not give anything by mouth to an unconscious person.

#### Avoid inhalation

If inhaled: Call a poison control center or doctor immediately for treatment advice. Have person sip a glass of water if able to swallow. Do not induce vomiting unless told to do so by a poison control center or doctor. Do not give anything by mouth to an unconscious person.

#### Avoid eye contact

If in eyes: Hold eye open and rinse slowly and gently with water for 15-20 minutes. Remove contact lenses, if present, after the first 5 minutes, then continue rinsing eye. Call a poison control center or doctor for treatment advice.

#### Avoid skin contact

If on skin or clothing: Take off contaminated clothing. Rinse skin immediately with plenty of water for 15-20 minutes. Call a poison control center or doctor for treatment advice.

- For Safety Data Sheets go to [www.interlux.com](http://www.interlux.com)
- For medical emergency, spill, leak, exposure or accident, call toll free – day or night – CHEMTREC 1-800-424-9300.
- Have the product container or label with you when calling a poison control center or doctor, or going for treatment. For medical emergencies, call the poison control center at 1-800-222-1222.

### Risk of fire or explosion

Most paints contain organic solvents – some of which evaporate into the air upon opening the container, which could pose inherent fire risks. Any dangers can be reduced if a few simple precautions are taken:

- **Avoid naked flames** where paint is being stored, opened or applied.
- **Do not smoke.**
- **Store paint in a well-ventilated, dry place** away from sources of heat and direct sunlight.
- **Keep the tin tightly closed.**
- **Avoid sparks** from metals, electrical appliances being switched on and off, or faulty electrical connections.
- **Do not leave paint soaked rags lying around**, in the pockets of overalls or in waste bins. **Some types of paint can dry out and auto-ignite.**

# Glossary of terms

## A

**Activator/Curing Agent:** Catalyst, hardener, accelerator, reactor; a material which accelerates a reaction

**Adhesion:** Bonding strength; the attraction of a coating to the substrate

---

## B

**Barrier Coat:** Coat used to allow application of a paint which is not compatible with an existing scheme

**Base:** Refers to the usual larger volume size of a two-pack system – usually the non-activator part. May also refer to any bare surface to be painted

---

## C

**Coverage Rate:** Non-technical number that tells you how much area you can paint with a given volume of material

**Curing:** Hardening

---

## D

**DOI (Distinction of Image):** Measurement of the clarity of the coating by its ability to reflect the image of a given object

**Dry Film Thickness (DFT):** The film thickness of paint after all of the solvent has evaporated from the wet paint

---

## F

**Film:** Any single coat or layer of paint applied to a surface, rather than a 'paint scheme'

**Film Build:** Dry thickness characteristics per coat

---

## G

**Gloss:** Sheen; ability to reflect; brightness

---

## O

**Opacity:** Hiding power

**Orange Peel:** Dimpled appearance of dried film; resembling orange peel

---

## P

**Pot Life:** Time interval after mixing during which liquid material is usable with no difficulty

**Primer:** First complete coat of paint of a painting system applied to a surface. Such paints are designed to provide adequate adhesion to new surfaces or are formulated to meet the special requirements of the surfaces

---

## R

**Resin:** A material, natural or synthetic, contained in varnishes, lacquers, and paints; the film former

---

## S

**SDS:** Abbreviation for Safety Data Sheet

**Sealer:** Paint used to seal the substrate or previous coats and prevent interaction between subsequent coats applied

**Substrate:** Surface to be painted

---

## T

**TDS:** Abbreviation for Technical Data Sheet

**Thinner:** A liquid used for reducing the viscosity of paints

**Tie Coat:** A coat of paint applied to a previous coat to improve the adhesion of subsequent coats or to prevent other surface defects e.g. bubbling of a subsequent coating

**Two-Pack:** Paints based on binders which cure by the chemical reaction between two components

---

## V

**Viscosity:** A measure of fluidity

---

## W

**Wet Edge:** Keeping the paint wet enough when it is applied by brush so it can be brushed back into without showing lines of demarcation from one painted area to the next

**Wet Film Thickness (WFT):** The thickness of paint when it is first applied before solvent evaporation takes place

---

# The perfect finish is right at your fingertips

There's a new, easy way to create your customised coating guide, for above and below the waterline.

Get step-by-step instructions with videos, and expert advice to help you achieve stunning results, in just one click.

**Everything you need, in one easy place!**  
**Check out [interlux.com](http://interlux.com) now!**



# It's what's under the surface that counts

Relentless performance  
for every yacht, everywhere,  
every time.



Available in all  
our Marine Mart  
stores

[info@marinemart.ca](mailto:info@marinemart.ca)

**[marinemart.ca](http://marinemart.ca)**